



Knights of Columbus Hockey Challenge



2024 Ontario State Package

Contacts

Anthony Viresi
State Chairman
416-241-1522
viresi_kofc@yahoo.com

Daniel Mainville
State Director – Community Programs
705-929-1565
communitydirector@ontariokofc.ca

Index

Introduction	Pg. 2
Program Overview	Pg. 3
Time Frame & Responsibilities	Pg. 4
Scoring Board for the Net	Pg. 5
Entry Form/Score Sheet	Pg. 6
Steps to a Successful Challenge	Pg. 7
Age Eligibility Chart as of Sept. 1 st	Pg. 8
Personal Notes	Pg. 9

Hello my Brothers,

I am happy to announce that I have accepted the State Chairman positions for the Hockey and Soccer Challenge programs for the upcoming 2023-2024 fraternal year. I look forward to working with all the District Deputies and the councils once again.

The last 4 years has been pretty difficult for everyone due to Covid and many of our programs had to be sidelined. Now that we have almost moved on from those difficult years we'd like to slowly start rebuilding all three of our sport activities. Currently I am working on updating the Ontario State packages for both the Hockey and Soccer Challenges that haven't been updated in the last 3-4 years. This package is a slightly modified package just for this year as I work to get it on par with the Free Throw Package.

I want to personally thank all of you who took part in both programs over the last 5 years and those who will be taking part in them again this year. Due to the lack of participation in both programs, even before Covid, I will be removing regional boundaries and the regional level of competition. Until participation increases to a point where the regional level is required, the district level will be the last level of competition before the state level. If there is only one council that participates within a district, then the council winners will be considered the district winners. Councils or District Deputies will scan and email the winning score sheets to the State Chairman and State Winners will be determined on paper.

If you have any questions, please don't hesitate to contact me or our State Community Program Director Bro. Daniel Mainville at CommunityDirector@ontariokofc.ca.

Thank you for volunteering your time and efforts in this year's Hockey & Soccer Challenges and I look forward to helping you make these program successful again.

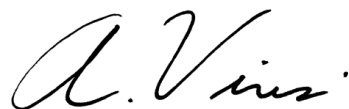

Bro. Anthony Viresi
State Hockey & Soccer Challenge Chairman
416-241-1522
viresi_kofc@yahoo.com

OVERVIEW

The Ontario Knights of Columbus Hockey Challenge is a competition designed for players to demonstrate their shooting skills in scoring hockey goals. The competition is open to all children ages 12-17. Children under 12 are welcome but compete at the age 12 level. Each player will be allowed 15 shots at the goal from the shot line. Winners progress to the district, regional and state competitions. This can be promoted through schools, Columbian Squires' Circles, Catholic Youth Organizations, Special Olympic Chapters or other community organizations and events hence giving us an opportunity to introduce our Order into a large community. Age eligibility is determined by the age of the contestant as of January 1st in the competition fraternal year. (January 1, 2024 for the 2023-2024 Fraternal Year). Proof of age is required.

The net will be divided into five scoring zones. The upper corners of the goal will be designated as 20 point zones. The lower corners will be designated as 10 point zones and the "five hole" is a five point zone. See instructions later in the guide on how to construct a score board with the five scoring zones. Allow no more than 3 practice or warm-up shots. Each participant will be given 15 shots. Points will be awarded depending upon the area of the scoring zones through which the puck or ball passes. Shot violations will include stepping on or over the shot line prior to the shot.

Any contact made with the puck/ball counts as a shot. Scorers should record shots made and missed according to the instructions on the entry form/score sheet. All scores should be verified before the next contestant is allowed to shoot. Judges and scorers are given final authority in verifying all scores and violations.

Entry Form: The entry form is included later in this guide. It must be fully completed to ensure youth and parental consent, and to be eligible for State level awards. Incomplete forms should be considered grounds for disqualification.

Participation Form: After the event has been conducted, Councils are requested to complete and submit the Participation Form found later in this guide, in order that Ontario State can assess and report on the success of this competition.

Equipment: To ensure maximum access to this competition at the council level, this may be done indoors or outdoors and can be held in a gym, local park, ice rink or another location facility approved by and under the supervision of a participating Knights of Columbus council. Ice hockey sticks, street hockey sticks, or gym floor hockey sticks may be used. Youth participants are encouraged to provide their own hockey stick. Ice hockey puck, street hockey puck or gym floor hockey puck or ball may be used. The only stipulation is that everyone competing at the council level has the same conditions and equipment to ensure a fair competition. The scoring board can be placed in front of an actual hockey net, or simply stood against the wall. For ease of transportation it is suggested that the scoring board be hinged in the middle. The shot line will be 3 metres from the front of the scoring board. Although the youth may shoot from anywhere along the shot line they may not cross the line in the act of shooting. The stick may cross the line as part of the follow-through but the puck or ball must have already been struck.

For the District and Regional competitions. The same equipment and conditions must be available for all participants although these may be different from the council level competition.

Categories: The age categories are 13 and under, 14-15, and 16-17. If a council wishes to conduct competitions at lower ages they are welcome to do so for local prize consideration but these youth will be considered part of age "13 and under" for District and higher level competition awards. Girls and boys will compete together in the age categories. A separate Special Olympian Category may be considered by the Council, District and Regional Chairman but will remain unisex.

Insurance. Insurance and liability considerations should be accessed in the same manner as other youth competitions or youth events.

SUGGESTED TIME FRAMES

The State deadline to receive entries is March 17th, 2024. Entries can be mailed, hand delivered or scanned and emailed but must reach the State Chairman by the deadline. Contact information is available on this document cover page.

State Winner Cross Referral: Winning entries will be cross referenced with council officer information to ensure that a valid Safe Environment certification is in force for the Council sponsoring the youth. Council failings will result in entry disqualification.

Council Level: Consider a September/October timeframe if running the Hockey Challenge as an outdoor event. In any case, Councils should plan on completing their Hockey Challenge event by **March 17th, 2024**. The Grand Knight shall ensure a certified safe environment leader is present for all council competitions. Councils should work with the schools, hockey clubs, and other youth organizations to provide maximum opportunity for youth in your area to participate.

Responsibilities

1) Council Level:

Organize and host the events. Deadline for council events should be established in coordination with the District Deputy but not later than March 17, 2024. Ensure a certified safe environment Family or Community Director is present for all council competitions. Complete the Hockey Participation Report form, (include your school competitions numbers with council numbers) This should be submitted immediately following the close of council competition

2) District & Regional Level

Due to the low level of participation throughout the province there will only be a council level of competition. All council winner score sheets will need to be submitted to the State Hockey Challenge Chairman **Bro. Anthony Viresi**.

Each participant must complete the Hockey Challenge Entry form and the information must include the individual's name, address, entrant signature, parent name and signature or witness, the affiliated Council Number, in addition to the participant's score at each level.

THE SCORING BOARD

Recommend a minimum 5/8th inch thick board, for durability (or metric equivalents)

Size 6 feet 6 inches wide by 4 feet high Allow a 2-inch border at the top edge. Allow a 3-inch border at each side.

The four pie shaped corner opening are based on a one foot radius The five hole is 3 inches high, 12 inches wide.

If board is hinged in the centre it will make it much easier to transport.

Your local council handyman may have better methods and material but simply ensure that the scoring zones are consistent. The craftsmen among you may want to attach nets to the back of each scoring zone... Can be set in front of a regulation net or simply next to a wall.

The puck/ball must pass completely through opening to count as a goal.

Upper corners count 20 points, lower corners count 10 points, Five hole is 5 points.

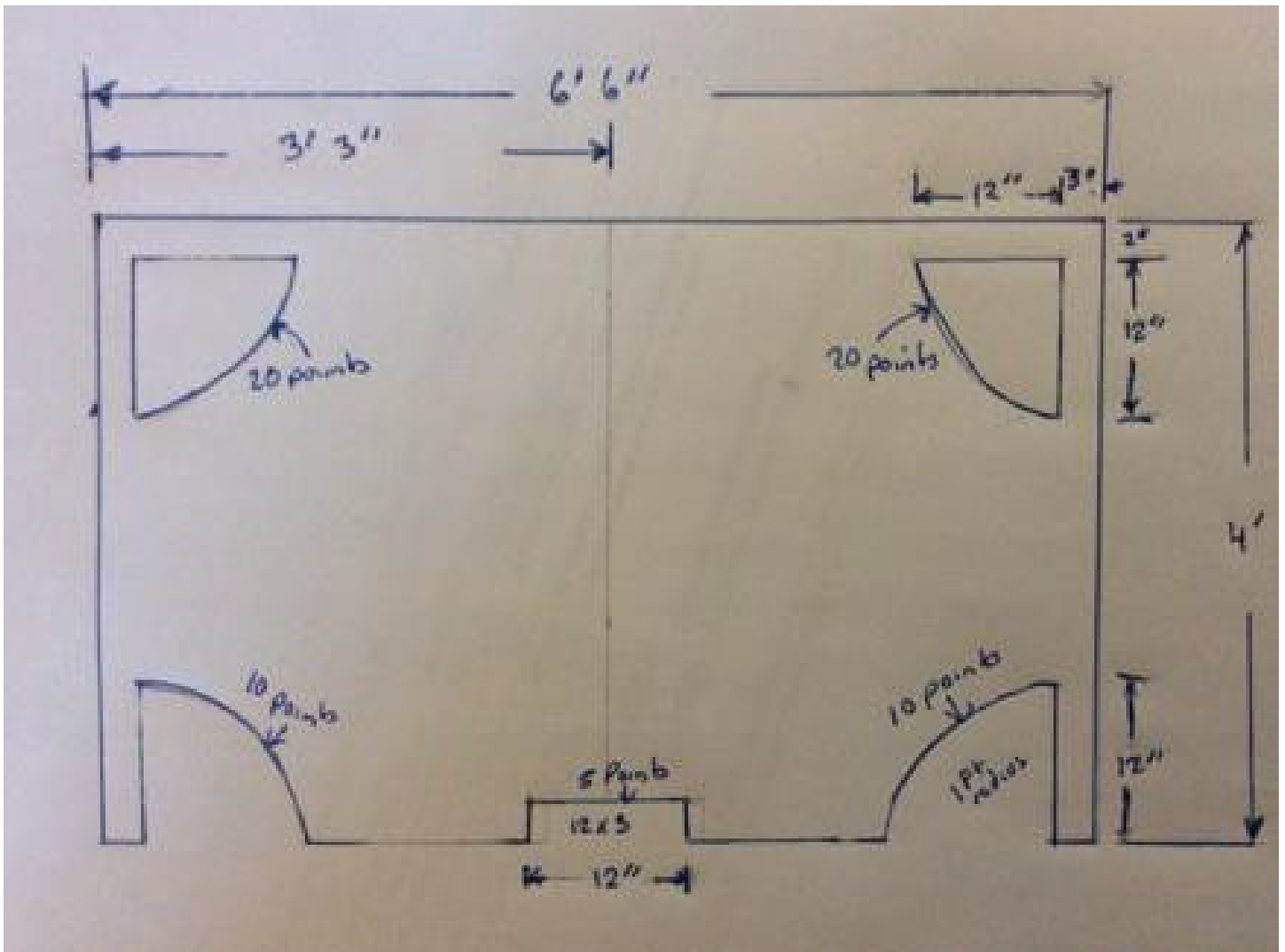

ONTARIO HOCKEY CHALLENGE REGISTRATION SCORING SHEET
(this form is used throughout the council, District and Region competition)

Category: Under 13 ☐ 14-15 ☐ 16-17 ☐ (AGE AS OF JANUARY 1, 2021)

Name of Entrant

Date of Birth

Street Address

City

State/Province

Postal Code

Telephone

Signature of entrant

Section 2: to be completed by Parent or legal Guardian. By signing below the undersigned requests and approves of the entrant's registration and participation in the Knights of Columbus Hockey Challenge (the contest). In consideration for the entrant's participation in the contest, the undersigned (1) acknowledges that the entrant's participation will be at the sole risk of the entrant and the undersigned (2) agrees to release, indemnify and the Knights of Columbus Ontario Council and its subordinate units, offers members and employees harmless from any and all demands, claims, or causes of action arising from or relating to the entrant's participation in the contest. The undersigned also agree to allow representative Knights of Columbus units to take and publish photographs or videos of the entrant during the contest. The entrant may compete in only one council level competition.

Parent or Guardian (Print)

Parent or Guardian (Signature)

date signed

**Scoring Instructions: Each contestant will be allowed 15 consecutive shots
(Tie breaker in three shots sessions as needed)**

Competition	Shot Record	Tie-Breaker as needed	Total
Council	Missed <input type="checkbox"/> <input type="checkbox"/> <input type="checkbox"/> <input type="checkbox"/> <input type="checkbox"/> <input type="checkbox"/> <input type="checkbox"/> <input type="checkbox"/> <input type="checkbox"/> <input type="checkbox"/> <input type="checkbox"/> <input type="checkbox"/> <input type="checkbox"/> <input type="checkbox"/> <input type="checkbox"/> <input type="checkbox"/> 5 pts <input type="checkbox"/> <input type="checkbox"/> <input type="checkbox"/> <input type="checkbox"/> <input type="checkbox"/> <input type="checkbox"/> <input type="checkbox"/> <input type="checkbox"/> <input type="checkbox"/> <input type="checkbox"/> <input type="checkbox"/> <input type="checkbox"/> <input type="checkbox"/> <input type="checkbox"/> <input type="checkbox"/> <input type="checkbox"/> 10 pts <input type="checkbox"/> <input type="checkbox"/> <input type="checkbox"/> <input type="checkbox"/> <input type="checkbox"/> <input type="checkbox"/> <input type="checkbox"/> <input type="checkbox"/> <input type="checkbox"/> <input type="checkbox"/> <input type="checkbox"/> <input type="checkbox"/> <input type="checkbox"/> <input type="checkbox"/> <input type="checkbox"/> <input type="checkbox"/> 20 pts <input type="checkbox"/> <input type="checkbox"/> <input type="checkbox"/> <input type="checkbox"/> <input type="checkbox"/> <input type="checkbox"/> <input type="checkbox"/> <input type="checkbox"/> <input type="checkbox"/> <input type="checkbox"/> <input type="checkbox"/> <input type="checkbox"/> <input type="checkbox"/> <input type="checkbox"/> <input type="checkbox"/> <input type="checkbox"/>	<input type="checkbox"/> <input type="checkbox"/> <input type="checkbox"/> <input type="checkbox"/> <input type="checkbox"/> <input type="checkbox"/> <input type="checkbox"/> <input type="checkbox"/> <input type="checkbox"/> <input type="checkbox"/> <input type="checkbox"/> <input type="checkbox"/> <input type="checkbox"/> <input type="checkbox"/> <input type="checkbox"/> <input type="checkbox"/> <input type="checkbox"/> <input type="checkbox"/> <input type="checkbox"/> <input type="checkbox"/> <input type="checkbox"/> <input type="checkbox"/> <input type="checkbox"/> <input type="checkbox"/> <input type="checkbox"/> <input type="checkbox"/> <input type="checkbox"/> <input type="checkbox"/> <input type="checkbox"/> <input type="checkbox"/> <input type="checkbox"/> <input type="checkbox"/> <input type="checkbox"/> <input type="checkbox"/> <input type="checkbox"/> <input type="checkbox"/> <input type="checkbox"/> <input type="checkbox"/> <input type="checkbox"/> <input type="checkbox"/> <input type="checkbox"/> <input type="checkbox"/> <input type="checkbox"/> <input type="checkbox"/> <input type="checkbox"/> <input type="checkbox"/> <input type="checkbox"/> <input type="checkbox"/> <input type="checkbox"/> <input type="checkbox"/> <input type="checkbox"/> <input type="checkbox"/> <input type="checkbox"/> <input type="checkbox"/> <input type="checkbox"/> <input type="checkbox"/> <input type="checkbox"/> <input type="checkbox"/> <input type="checkbox"/> <input type="checkbox"/> <input type="checkbox"/> <input type="checkbox"/> <input type="checkbox"/> <input type="checkbox"/>	
Council # _____ Chairman: _____ Print and Sign			
District	Missed <input type="checkbox"/> <input type="checkbox"/> <input type="checkbox"/> <input type="checkbox"/> <input type="checkbox"/> <input type="checkbox"/> <input type="checkbox"/> <input type="checkbox"/> <input type="checkbox"/> <input type="checkbox"/> <input type="checkbox"/> <input type="checkbox"/> <input type="checkbox"/> <input type="checkbox"/> <input type="checkbox"/> <input type="checkbox"/> 5 pts <input type="checkbox"/> <input type="checkbox"/> <input type="checkbox"/> <input type="checkbox"/> <input type="checkbox"/> <input type="checkbox"/> <input type="checkbox"/> <input type="checkbox"/> <input type="checkbox"/> <input type="checkbox"/> <input type="checkbox"/> <input type="checkbox"/> <input type="checkbox"/> <input type="checkbox"/> <input type="checkbox"/> <input type="checkbox"/> 10 pts <input type="checkbox"/> <input type="checkbox"/> <input type="checkbox"/> <input type="checkbox"/> <input type="checkbox"/> <input type="checkbox"/> <input type="checkbox"/> <input type="checkbox"/> <input type="checkbox"/> <input type="checkbox"/> <input type="checkbox"/> <input type="checkbox"/> <input type="checkbox"/> <input type="checkbox"/> <input type="checkbox"/> <input type="checkbox"/> 20 pts <input type="checkbox"/> <input type="checkbox"/> <input type="checkbox"/> <input type="checkbox"/> <input type="checkbox"/> <input type="checkbox"/> <input type="checkbox"/> <input type="checkbox"/> <input type="checkbox"/> <input type="checkbox"/> <input type="checkbox"/> <input type="checkbox"/> <input type="checkbox"/> <input type="checkbox"/> <input type="checkbox"/> <input type="checkbox"/>	<input type="checkbox"/> <input type="checkbox"/> <input type="checkbox"/> <input type="checkbox"/> <input type="checkbox"/> <input type="checkbox"/> <input type="checkbox"/> <input type="checkbox"/> <input type="checkbox"/> <input type="checkbox"/> <input type="checkbox"/> <input type="checkbox"/> <input type="checkbox"/> <input type="checkbox"/> <input type="checkbox"/> <input type="checkbox"/> <input type="checkbox"/> <input type="checkbox"/> <input type="checkbox"/> <input type="checkbox"/> <input type="checkbox"/> <input type="checkbox"/> <input type="checkbox"/> <input type="checkbox"/> <input type="checkbox"/> <input type="checkbox"/> <input type="checkbox"/> <input type="checkbox"/> <input type="checkbox"/> <input type="checkbox"/> <input type="checkbox"/> <input type="checkbox"/> <input type="checkbox"/> <input type="checkbox"/> <input type="checkbox"/> <input type="checkbox"/> <input type="checkbox"/> <input type="checkbox"/> <input type="checkbox"/> <input type="checkbox"/> <input type="checkbox"/> <input type="checkbox"/> <input type="checkbox"/> <input type="checkbox"/> <input type="checkbox"/> <input type="checkbox"/> <input type="checkbox"/> <input type="checkbox"/> <input type="checkbox"/> <input type="checkbox"/> <input type="checkbox"/> <input type="checkbox"/> <input type="checkbox"/> <input type="checkbox"/> <input type="checkbox"/> <input type="checkbox"/> <input type="checkbox"/> <input type="checkbox"/> <input type="checkbox"/> <input type="checkbox"/> <input type="checkbox"/> <input type="checkbox"/> <input type="checkbox"/> <input type="checkbox"/>	
District # _____ Chairman: _____ Print and Sign			
Regional	Missed <input type="checkbox"/> <input type="checkbox"/> <input type="checkbox"/> <input type="checkbox"/> <input type="checkbox"/> <input type="checkbox"/> <input type="checkbox"/> <input type="checkbox"/> <input type="checkbox"/> <input type="checkbox"/> <input type="checkbox"/> <input type="checkbox"/> <input type="checkbox"/> <input type="checkbox"/> <input type="checkbox"/> <input type="checkbox"/> 5 pts <input type="checkbox"/> <input type="checkbox"/> <input type="checkbox"/> <input type="checkbox"/> <input type="checkbox"/> <input type="checkbox"/> <input type="checkbox"/> <input type="checkbox"/> <input type="checkbox"/> <input type="checkbox"/> <input type="checkbox"/> <input type="checkbox"/> <input type="checkbox"/> <input type="checkbox"/> <input type="checkbox"/> <input type="checkbox"/> 10 pts <input type="checkbox"/> <input type="checkbox"/> <input type="checkbox"/> <input type="checkbox"/> <input type="checkbox"/> <input type="checkbox"/> <input type="checkbox"/> <input type="checkbox"/> <input type="checkbox"/> <input type="checkbox"/> <input type="checkbox"/> <input type="checkbox"/> <input type="checkbox"/> <input type="checkbox"/> <input type="checkbox"/> <input type="checkbox"/> 20 pts <input type="checkbox"/> <input type="checkbox"/> <input type="checkbox"/> <input type="checkbox"/> <input type="checkbox"/> <input type="checkbox"/> <input type="checkbox"/> <input type="checkbox"/> <input type="checkbox"/> <input type="checkbox"/> <input type="checkbox"/> <input type="checkbox"/> <input type="checkbox"/> <input type="checkbox"/> <input type="checkbox"/> <input type="checkbox"/>	<input type="checkbox"/> <input type="checkbox"/> <input type="checkbox"/> <input type="checkbox"/> <input type="checkbox"/> <input type="checkbox"/> <input type="checkbox"/> <input type="checkbox"/> <input type="checkbox"/> <input type="checkbox"/> <input type="checkbox"/> <input type="checkbox"/> <input type="checkbox"/> <input type="checkbox"/> <input type="checkbox"/> <input type="checkbox"/> <input type="checkbox"/> <input type="checkbox"/> <input type="checkbox"/> <input type="checkbox"/> <input type="checkbox"/> <input type="checkbox"/> <input type="checkbox"/> <input type="checkbox"/> <input type="checkbox"/> <input type="checkbox"/> <input type="checkbox"/> <input type="checkbox"/> <input type="checkbox"/> <input type="checkbox"/> <input type="checkbox"/> <input type="checkbox"/> <input type="checkbox"/> <input type="checkbox"/> <input type="checkbox"/> <input type="checkbox"/> <input type="checkbox"/> <input type="checkbox"/> <input type="checkbox"/> <input type="checkbox"/> <input type="checkbox"/> <input type="checkbox"/> <input type="checkbox"/> <input type="checkbox"/> <input type="checkbox"/> <input type="checkbox"/> <input type="checkbox"/> <input type="checkbox"/> <input type="checkbox"/> <input type="checkbox"/> <input type="checkbox"/> <input type="checkbox"/> <input type="checkbox"/> <input type="checkbox"/> <input type="checkbox"/> <input type="checkbox"/> <input type="checkbox"/> <input type="checkbox"/> <input type="checkbox"/> <input type="checkbox"/> <input type="checkbox"/> <input type="checkbox"/> <input type="checkbox"/> <input type="checkbox"/>	
Region# _____ Chairman: _____ Print and Sign			

Six Steps to a Successful Hockey Challenge

Hockey Competition Guidelines for Council & District

Before the Event

1) Select the Venue and Book Facilities:

- Determine whether you want an outdoor or indoor event. Consider partnering with an existing hockey tournament, event, league, or minor hockey association. Also consider conducting the event in a local school.
- Coordinate with a minor hockey association during a tournament or “Hockey Day” celebration
- If your local minor hockey association spans multiple locations served by multiple Councils consider running your event in partnership with your local district Councils
- Coordinate with a street hockey tournament or league in the community. Contact the venue you want to use and book the facility as required for the Competition. For schools determine if you need to book through the School Boards Permit office. Also, ask the permit office about the Ministry of Education Community Use of Schools Grant and if a separate form need to be filled out to obtain a volunteer group discounted rate.

2) Construct your Scoring Board(s)

- Construct your scoring board as described in this package with a KofC logo and your Council name on the board.

3) Promote the Event

- Supply posters to each school and/or venue for display to advertise your competition.
- Make contact with the teacher who is most likely to run a school competition of this sort (phys. Ed teacher, athletic director, classroom teacher, etc.) and provide him or her with the necessary information and materials.
- Contact officials from the town recreation department or local street hockey or minor hockey association to promote the competition among their players.

4) Organize your volunteers - You'll Need lots of Help!

- 1-2 Brother Knights to register players and organize groups by age categories
- 2 Brother Knights per net as judges and scorers to count and record each shot on the participant form and tally the totals
- 1-2 puck/ball retrievers per net
- Extra helpers to fill in, run forms from registration table to scorers, and anything else that comes up to keep everything running smoothly

The Day of the Competition

5) Set-up

- Set up nets and scoring boards
- On the gym floor mark the shooting line 3 meters from the net with “no residue” tape
- If competing in a gymnasium or on a similar floor surface, consider using a plywood or plastic shooting platform to avoid marking the floor
- Determine if you are providing juice, water, doughnuts for after the competition and set them up appropriately
- Set up registration tables and chairs

6) When the Participants Arrive

- Have participants or their parents fill out the Entry Form/Score Sheet. Ensure that they check the correct age box, that at least one parent has signed the form and that all the required information such as D.O.B., mailing address, phone number and council number is filled out and legible
- Make sure there are Bro. Knights in the gym during registration and warm-ups to direct participants to the net, and to answer any question they or parents may have.
- Make sure they are given full and clear instructions before the competition begins.
- Announce the winners, hand out certificates and information on the District competition.

Knights of Columbus

2023 – 2024

Basketball Free Throw Competition

Age Eligibility Chart as of Jan. 1st 2024

The date of birth to be eligible to compete within our 10 to 17 year old age groups needs to be Jan. 1st, 2014 or before.

From	To	Year	Age
January 2nd	December 31st	2013	10
January 2nd	December 31st	2012	11
January 2nd	December 31st	2011	12
January 2nd	December 31st	2010	13
January 2nd	December 31st	2009	14
January 2nd	December 31st	2008	15
January 2nd	December 31st	2007	16
January 2nd	December 31st	2006	17

Born On		Year	Age
January 1st		2014	10
January 1st		2013	11
January 1st		2012	12
January 1st		2011	13
January 1st		2010	14
January 1st		2009	15
January 1st		2008	16
January 1st		2007	17

NOTES:

This image shows a full page of blank white paper with horizontal ruling lines. The lines are evenly spaced and run across the width of the page. There are no margins, text, or other markings present.